

HANDLE SECTIONS

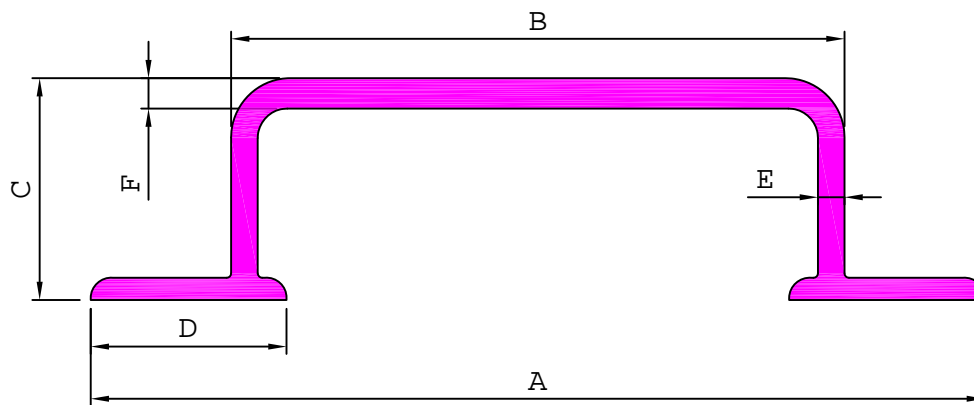

| SL. No. | Section No. | A | B | C | D | E | F | Weight kg/m |
|---------|-------------|--------|--------|-------|-------|------|------|-------------|
| 1 | 18586 | 148.80 | 106.50 | 33.00 | 27.30 | 3.90 | 4.20 | 2.105 |
| 2 | 18640 | 149.50 | 107.00 | 31.00 | 30.50 | 3.85 | 3.85 | 2.066 |
| 3 | 18619 | 150.00 | 110.00 | 34.00 | 30.00 | 3.45 | 3.60 | 1.995 |
| 4 | 18572 | 150.00 | 110.00 | 34.00 | 30.00 | 3.66 | 3.66 | 2.127 |
| 5 | 18620 | 150.00 | 110.00 | 34.00 | 30.00 | 4.00 | 4.10 | 2.248 |
| 6 | 18571 | 150.00 | 110.00 | 34.00 | 30.00 | 4.32 | 4.32 | 2.374 |

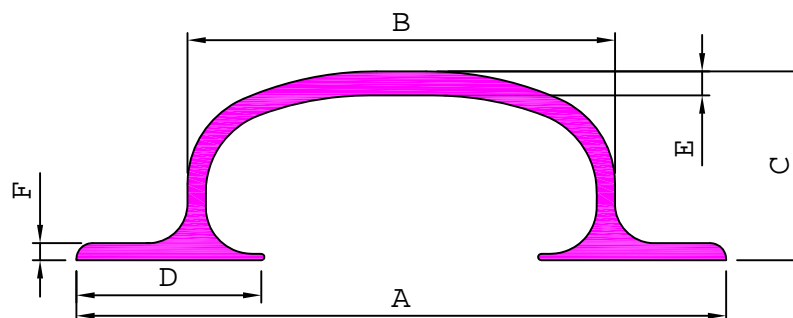

| SL. No. | Section No. | A | B | C | D | E | F | Weight kg/m |
|---------|-------------|--------|-------|-------|-------|------|------|-------------|
| 1 | 18611 | 123.00 | 82.50 | 34.50 | 30.00 | 2.45 | 2.20 | 1.258 |
| 2 | 18587 | 127.00 | 84.00 | 37.00 | 36.50 | 3.35 | 2.85 | 1.742 |
| 3 | 18621 | 127.00 | 84.00 | 37.00 | 36.50 | 3.90 | 3.10 | 1.996 |
| 4 | 18630 | 128.00 | 84.00 | 37.00 | 30.00 | 3.30 | 3.00 | 1.647 |
| 5 | 18613 | 128.00 | 84.00 | 37.00 | 30.00 | 3.50 | 3.10 | 1.724 |
| 6 | 18622 | 142.00 | 98.00 | 37.00 | 38.50 | 4.15 | 3.20 | 2.270 |
| 7 | 18631 | 143.00 | 99.00 | 36.00 | 32.00 | 3.70 | 2.70 | 1.921 |

HANDLE SECTIONS

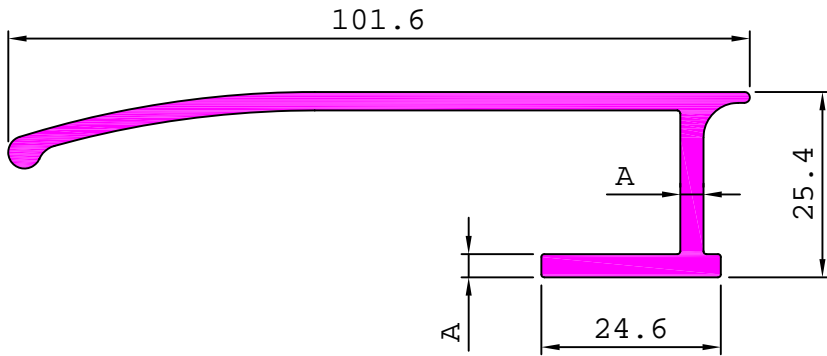

| SL. No. | Section No. | A | Weight kg/m |
|---------|-------------|------|-------------|
| 1 | 18553 | 3.18 | 1.093 |
| 2 | 18604 | 2.10 | 0.852 |

18563

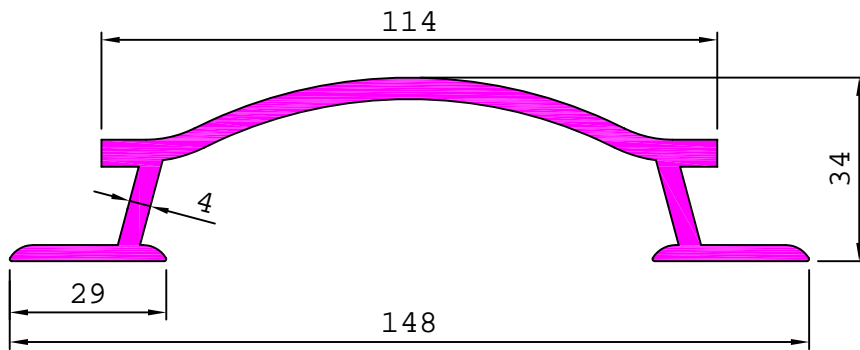

2.091 kg/m

18576

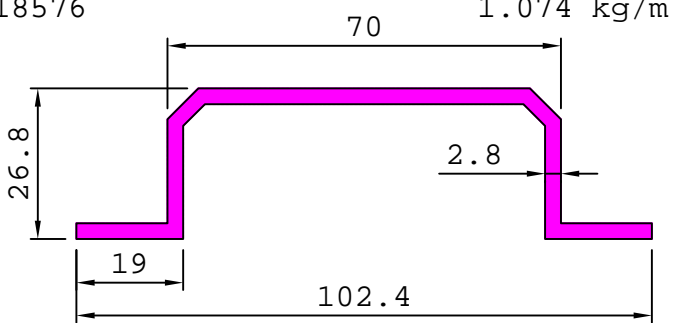

1.074 kg/m

18558

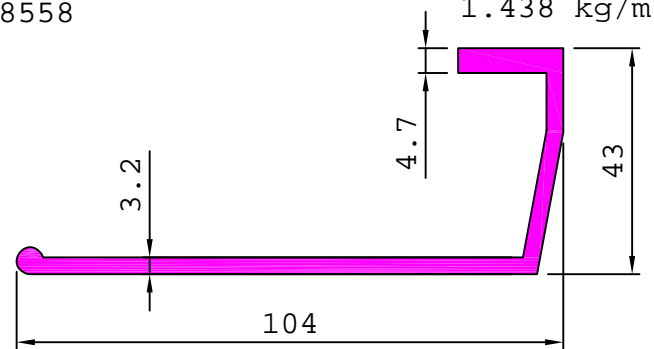

1.438 kg/m

18560

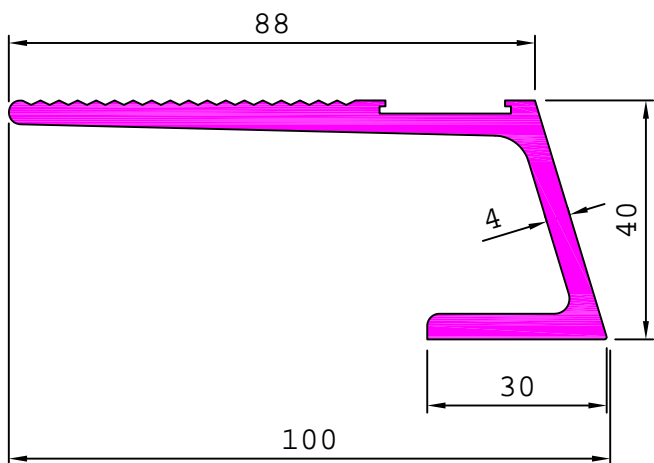

1.709 kg/m

18570

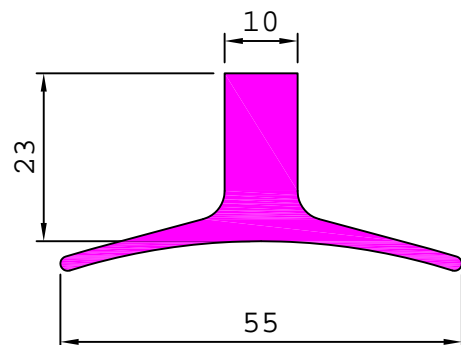

0.942 kg/m

HANDLE SECTIONS

18565

0.491 kg/m

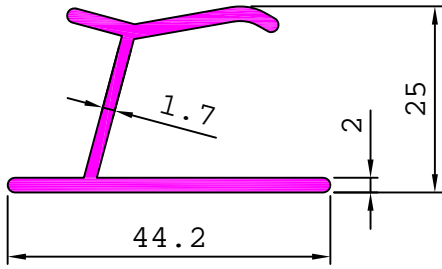

18641

0.707 kg/m

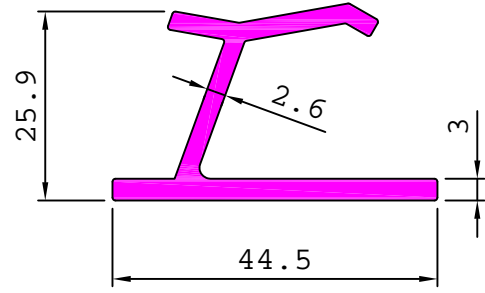

18643

7.668 kg/m

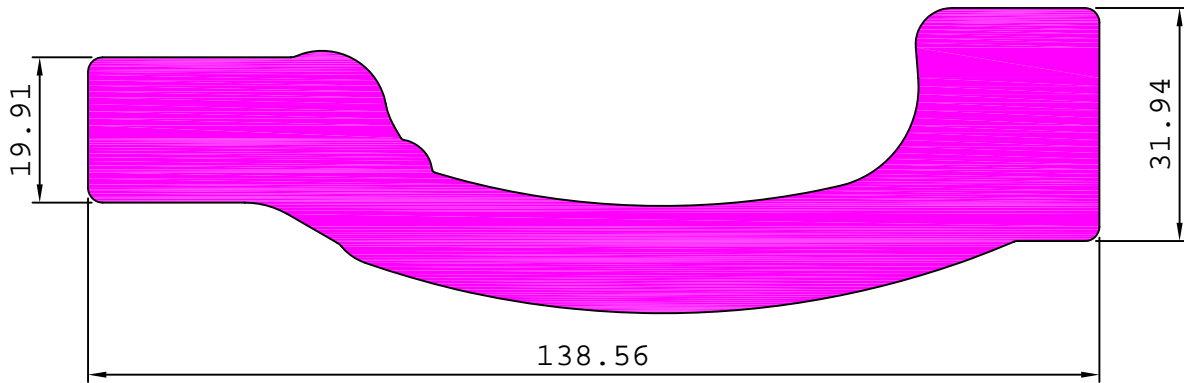

18644

9.441 kg/m

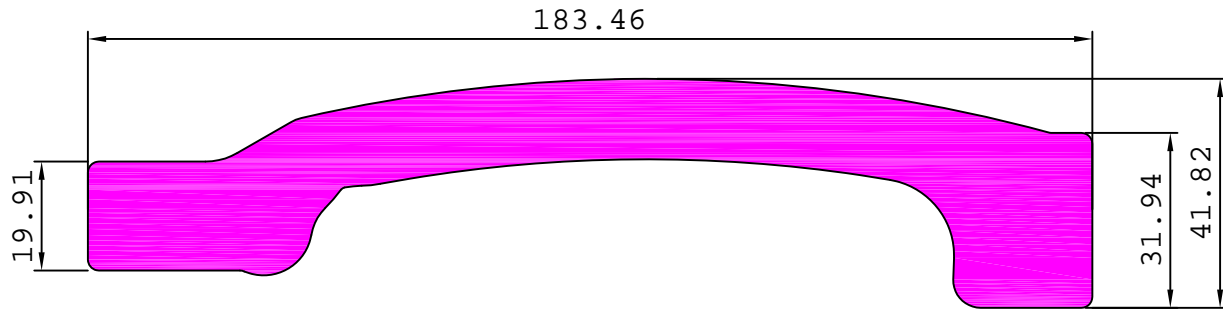

29426

13.076 kg/m

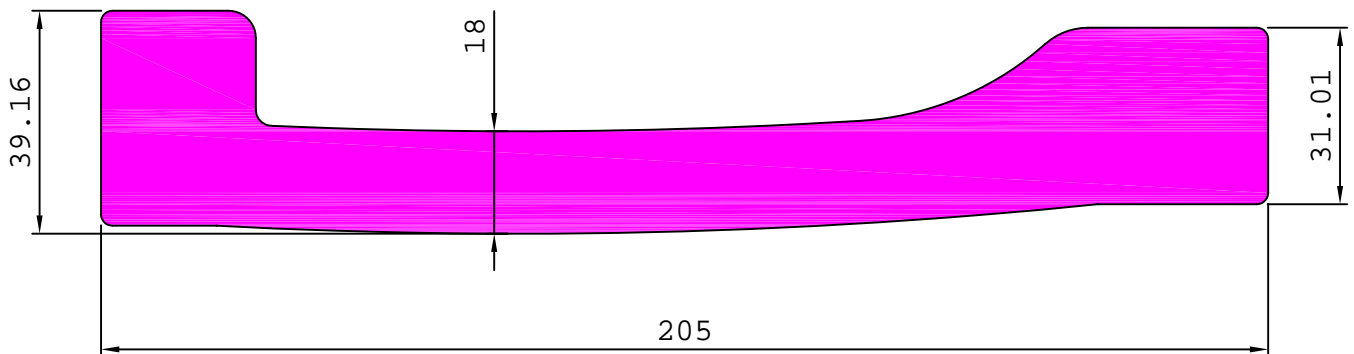

HANDLE SECTIONS

S4889

4.700 kg/m

