

HANDLE SECTIONS

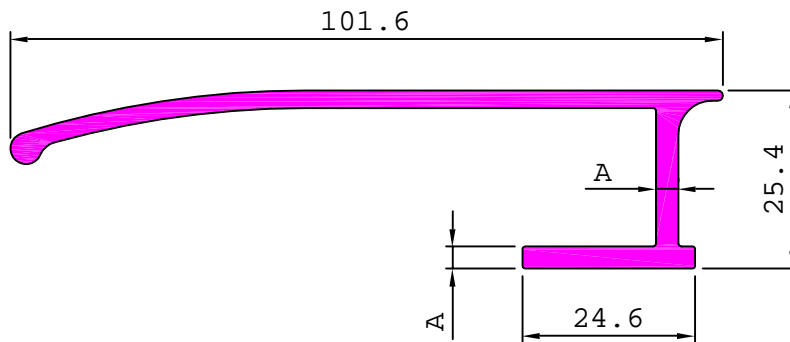

SL. No.	Section No.	A	Weight kg/m
1	18553	3.18	1.093
2	18604	2.10	0.852

18555 0.686 kg/m

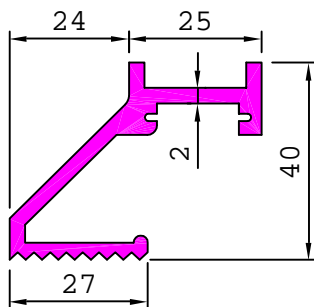

18558 1.438 kg/m

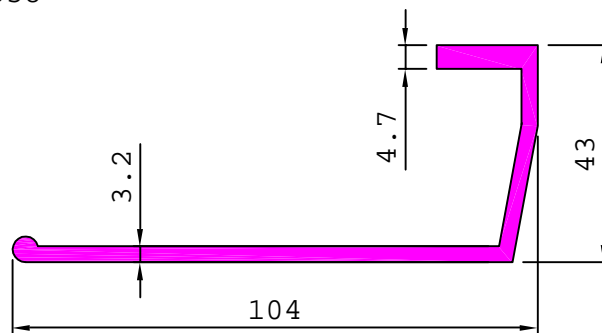

18560 1.709 kg/m

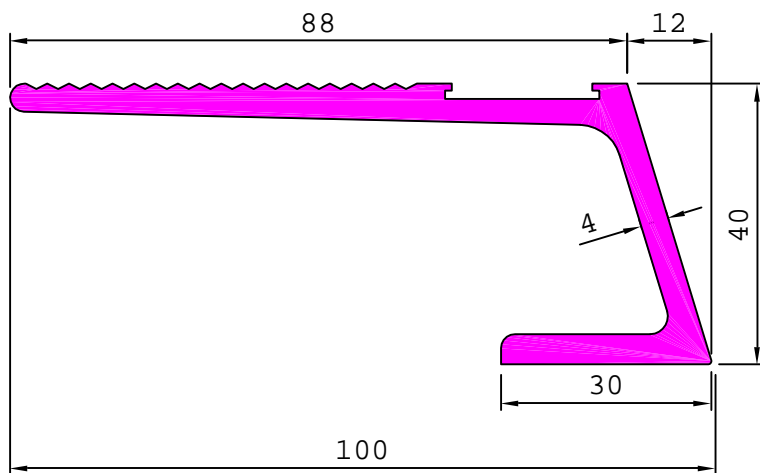

18565 0.491 kg/m

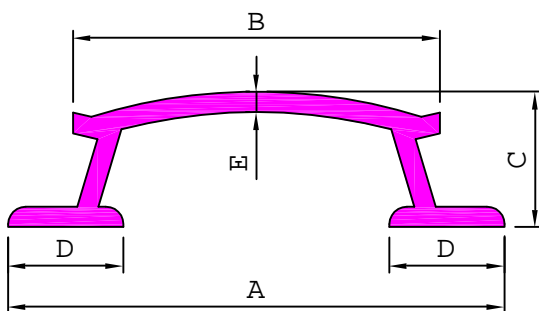
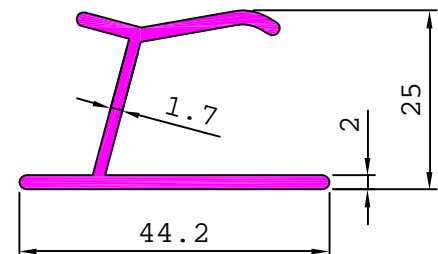

SL. No.	Section No.	A	B	C	D	E	Weight kg/m
1	18626	119.00	88.00	34.00	28.00	2.50	1.229
2	18598	119.00	88.00	34.00	28.00	3.10	1.422
3	18582	119.00	88.00	34.00	28.00	5.00	2.105
4	18562	122.00	90.00	32.00	29.00	3.80	1.920
5	18580	127.00	89.00	31.50	29.50	3.10	1.560
6	18627	144.00	112.00	35.00	28.00	2.90	1.503
7	18599	144.00	112.00	35.00	28.00	3.35	1.695
8	18583	144.00	112.00	35.00	28.00	4.80	2.378
9	18563	148.00	114.00	34.00	29.00	4.00	2.091
10	18581	148.50	114.00	34.80	30.00	3.40	1.819

HANDLE SECTIONS

18570

0.942 kg/m

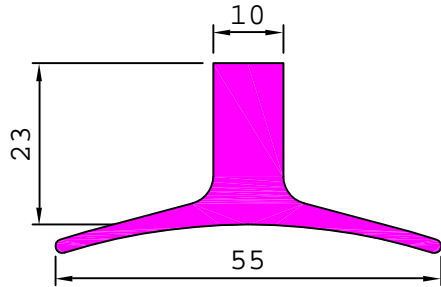

18577

0.351 kg/m

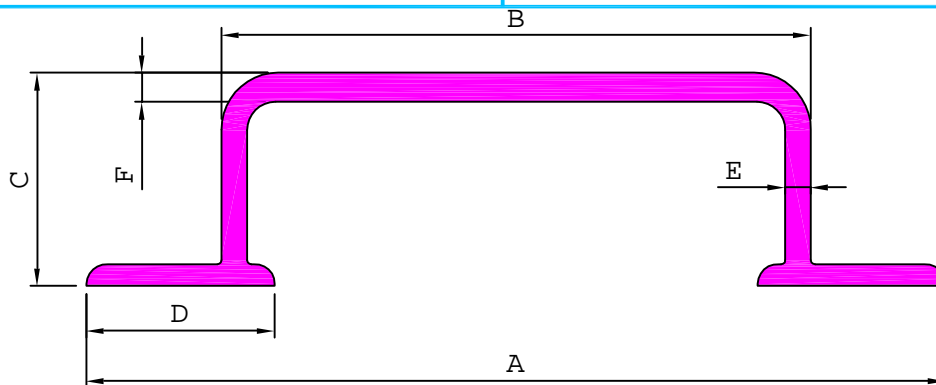
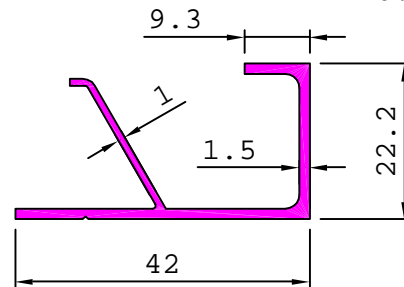

SL. No.	Section No.	A	B	C	D	E	F	Weight kg/m
1	18593	98.00	62.00	24.00	24.00	2.37	2.37	0.875
2	18624	121.00	83.00	30.00	26.50	2.90	3.60	1.502
3	18605	121.00	83.00	30.00	26.50	3.10	3.90	1.613
4	18617	121.00	83.00	30.00	26.50	3.60	4.10	1.720
5	18597	123.00	82.00	29.00	26.50	2.60	3.50	1.408
6	18585	123.60	85.00	33.00	26.30	3.80	4.20	1.832
7	18609	124.80	85.00	34.00	30.00	2.50	2.50	1.367
8	18569	124.80	85.00	34.00	30.00	3.40	3.40	1.759
9	18618	124.80	85.00	34.00	30.00	4.00	4.20	1.992
10	18602	126.00	84.00	30.50	29.70	4.15	4.20	1.917
11	18573	126.00	86.00	34.00	30.00	4.42	4.42	2.104
12	18623	137.60	97.00	29.40	24.80	2.40	2.70	1.277
13	18596	143.00	99.00	29.00	28.00	2.90	3.50	1.668
14	18625	143.00	105.00	30.00	26.50	3.10	3.60	1.780
15	18606	143.00	105.00	30.00	26.50	3.20	4.00	1.885
16	18568	147.80	108.00	34.00	30.00	3.25	3.25	1.886
17	18586	148.80	106.50	33.00	27.30	3.90	4.20	2.105
18	18603	149.50	107.00	31.00	30.50	4.00	4.00	2.192
19	18619	150.00	110.00	34.00	30.00	3.45	3.60	1.995
20	18572	150.00	110.00	34.00	30.00	3.66	3.66	2.127
21	18620	150.00	110.00	34.00	30.00	4.00	4.10	2.248
22	18571	150.00	110.00	34.00	30.00	4.32	4.32	2.374
23	18628	121.00	83.00	30.00	26.50	3.90	3.90	1.652
24	18629	150.00	110.00	34.00	30.00	3.40	3.40	1.925
25	18634	126.00	84.00	30.50	29.70	3.80	3.80	1.798
26	18638	142.00	99.00	29.50	27.20	2.20	2.20	1.337
27	18639	123.00	82.00	29.00	26.50	2.00	2.60	1.075
28	18640	149.50	107.00	31.00	30.50	3.85	3.85	2.066

HANDLE SECTIONS

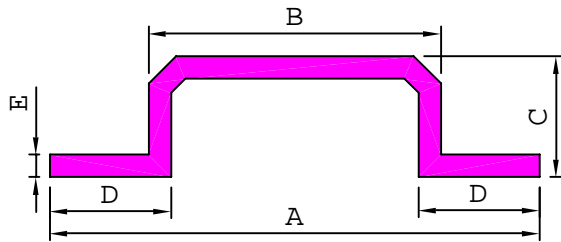

SL. No.	Section No.	A	B	C	D	E	Weight kg/m
1	18592	83.40	51.00	24.00	18.20	2.00	0.685
2	18575	83.40	51.00	24.00	19.20	3.00	0.951
3	18554	101.60	76.20	31.75	16.20	3.81	1.467
4	18591	102.40	70.00	26.80	18.40	1.98	0.885
5	18576	102.40	70.00	26.80	19.00	2.80	1.074

18584

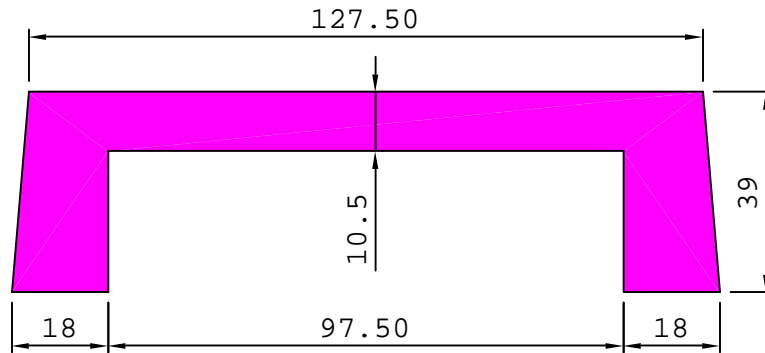

6.239 kg/m

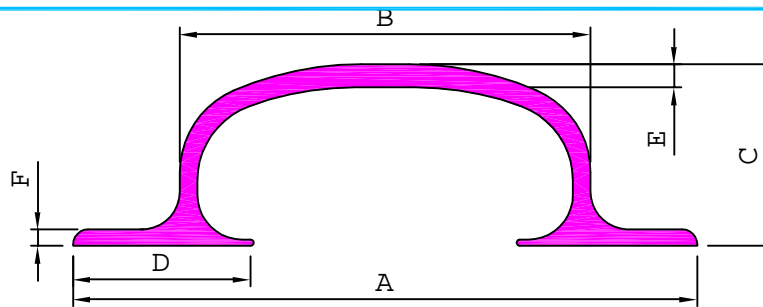

SL. No.	Section No.	A	B	C	D	E	F	Weight kg/m
1	18610	100.70	64.50	27.80	32.00	2.35	1.80	0.958
2	18611	123.00	82.50	34.50	30.00	2.45	2.20	1.258
3	18594	123.00	82.50	34.50	30.00	2.87	2.50	1.422
4	18607	126.00	83.50	36.00	30.00	3.40	2.45	1.613
5	18600	127.00	84.00	37.00	36.50	3.10	2.75	1.672
6	18587	127.00	84.00	37.00	36.50	3.65	3.00	1.912
7	18621	127.00	84.00	37.00	36.50	3.90	3.10	1.996
8	18612	128.00	84.00	37.00	30.00	3.00	2.80	1.530
9	18613	128.00	84.00	37.00	30.00	3.50	3.10	1.724
10	18614	140.00	98.00	34.50	30.00	2.90	2.35	1.531
11	18595	140.00	98.00	34.50	30.00	3.25	2.60	1.695
12	18601	142.00	98.00	37.00	38.50	3.50	2.70	1.946
13	18588	142.00	98.00	37.00	38.50	3.90	3.00	2.156
14	18622	142.00	98.00	37.00	38.50	4.15	3.20	2.270
15	18615	143.00	99.00	36.00	32.00	3.40	2.55	1.805
16	18608	143.00	99.00	36.00	32.00	3.60	2.65	1.885
17	18616	143.00	99.00	36.00	32.00	3.90	2.70	1.994
18	18630	128.00	84.00	37.00	30.00	3.30	3.00	1.647
19	18631	143.00	99.00	36.00	32.00	3.70	2.70	1.921
20	18632	127.00	84.00	37.00	36.50	3.40	2.90	1.790
21	18633	142.00	98.00	37.00	38.50	3.70	3.00	2.062
22	18635	123.00	82.50	34.50	30.00	2.05	2.00	1.079
23	18636	140.00	98.00	34.50	30.00	2.45	2.30	1.351

HANDLE SECTIONS & HASP & STAPLE

18637

1.584 kg/m

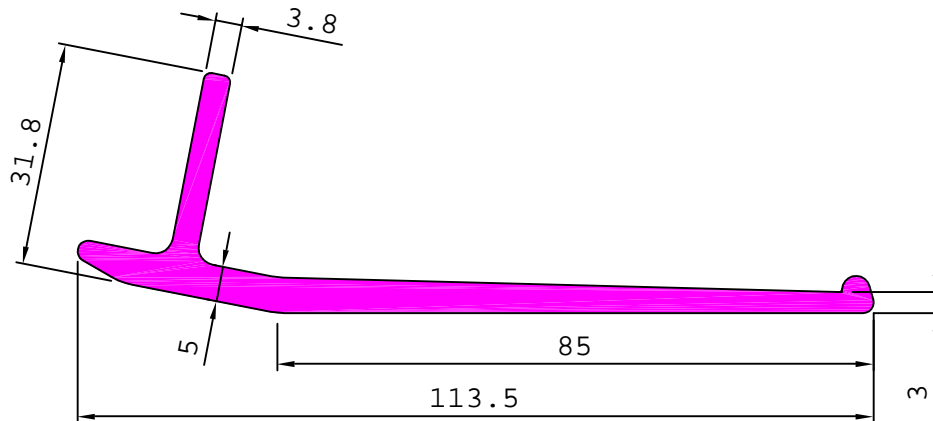

18641

0.707 kg/m

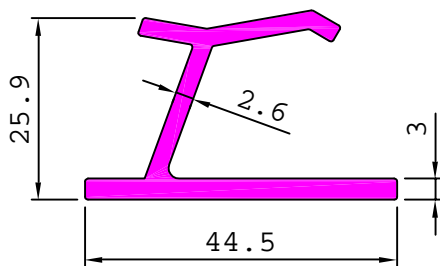

18642

2.700 kg/m

