

## CHANNELS AND TEES

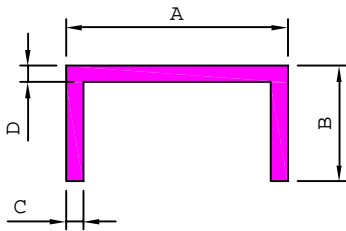

SL. No.	Section No.	A	B	C	D	Weight kg/m
109	15671	87.90	13.00	2.60	2.60	0.764
110	15762	100.00	25.00	1.50	1.50	0.595
111	15680	100.00	25.00	2.00	2.00	0.788
112	15709	100.00	30.00	1.10	1.10	0.468
113	15651	101.60	12.70	3.00	3.00	0.980
114	15725	101.60	50.80	5.00	5.00	2.608
115	15723	101.60	50.80	6.35	6.35	3.266
116	15703	110.00	25.00	2.00	2.00	0.842
117	15729	130.00	67.50	11.60	11.60	7.573
118	15714	170.00	30.30	10.30	10.30	5.840

### CHANNELS - ROUND FILLET TOES

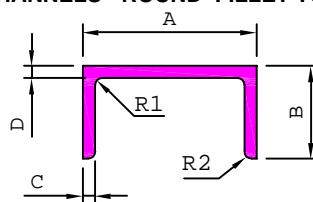

SL. No.	Section No.	A	B	C	D	R1	R2	Weight kg/m
1	16002	44.45	25.40	3.18	3.18	4.57	-	0.787
2	16014	50.80	31.75	6.65	4.40	3.25	-	1.597
3	16016	75.00	35.00	6.00	6.00	3.00	-	2.164
4	16010	75.00	40.00	5.00	5.00	5.00	-	1.986
5	16003	76.20	38.10	7.94	6.35	8.50	4.50	2.728
6	16004	100.00	25.00	2.00	2.00	2.00	-	0.792
7	16015	100.00	50.00	1.80	1.80	1.50	-	1.061
8	16007	101.60	41.83	6.68	6.68	9.52	-	3.205
9	16001	101.60	50.80	7.90	6.40	9.10	-	3.746
10	16011	125.00	55.00	6.50	6.50	6.00	-	3.938
11	16006	140.00	50.00	8.00	8.00	6.00	-	4.881
12	16005	140.00	70.00	8.00	8.00	6.00	-	5.745
13	16012	160.00	79.50	10.00	10.00	1.00	-	8.072
14	16017	203.20	65.00	11.84	11.84	12.70	-	10.081

### TEES - SQUARE FILLET TOES

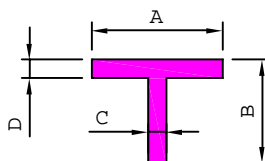

SL. No.	Section No.	A	B	C	D	Weight kg/m
1	16134	11.50	11.50	0.58	0.58	0.035
2	16127	12.70	12.70	0.56	0.56	0.038
3	16102	12.70	12.70	1.70	1.70	0.109
4	16135	17.00	17.00	0.51	0.51	0.046
5	16141	18.80	18.80	2.00	2.00	0.192
6	16139	18.80	18.80	2.30	2.30	0.219
7	16128	19.05	19.05	0.66	0.66	0.067
8	16103	19.05	19.05	1.45	1.45	0.144
9	16143	19.05	19.05	1.00	1.00	0.100
10	16104	19.05	19.05	3.18	3.18	0.299
11	16105	19.05	25.40	3.18	3.18	0.354

SL. No.	Section No.	A	B	C	D	Weight kg/m
12	16142	21.70	22.50	1.80	1.80	0.206
13	16107	22.22	25.40	3.18	3.18	0.381
14	16124	24.00	24.00	2.16	2.16	0.268
15	16144	24.00	24.00	0.73	0.73	0.093
16	16140	24.00	31.00	4.40	4.40	0.601
17	16133	25.00	12.70	1.10	1.10	0.109
18	16130	25.00	21.00	2.35	2.35	0.276
19	16131	25.40	25.40	0.83	0.83	0.111
20	16129	25.40	25.40	1.22	1.22	0.163
21	16108	25.40	25.40	1.60	1.60	0.212
22	16125	25.40	25.40	2.60	2.60	0.338

## TEES

SL. No.	Section No.	A	B	C	D	Weight kg/m
23	16109	25.40	25.40	3.18	3.18	0.409
24	16110	25.40	38.10	3.96	3.96	0.636
25	16123	30.00	25.00	3.00	3.00	0.421
26	16122	30.00	30.00	2.00	2.00	0.312
27	16111	31.75	31.75	1.60	1.60	0.267
28	16112	31.75	38.10	1.60	1.60	0.294
29	16136	38.00	38.00	2.00	2.00	0.400

SL. No.	Section No.	A	B	C	D	Weight kg/m
30	16113	38.10	20.32	1.27	1.27	0.195
31	16138	38.10	25.40	5.00	5.00	0.790
32	16118	38.10	38.10	1.60	1.60	0.322
33	16115	38.10	38.10	3.18	3.18	0.627
34	16121	38.10	38.10	4.80	4.80	0.925
35	16116	41.28	28.58	1.27	1.27	0.234
36	16117	50.80	38.10	4.78	4.78	1.085

### TEES - ROUND FILLET TOES

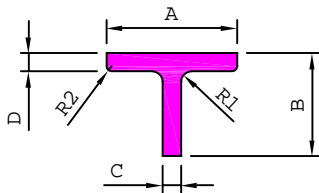

SL. No.	Section No.	A	B	C	D	R1	R2	Weight kg/m
1	16305	24.50	24.00	2.07	2.07	1.00	-	0.260
2	16304	24.50	24.00	2.40	2.40	2.50	-	0.306
3	16303	24.50	24.65	2.70	3.00	2.75	-	0.364
4	16306	24.50	24.65	2.85	3.10	2.75	-	0.379
5	16302	25.00	25.00	2.80	2.80	3.00	3.50	0.352
6	16301	25.40	25.40	3.18	3.18	4.57	3.00	0.422

### EQUAL ANGLES - SQUARE FILLET

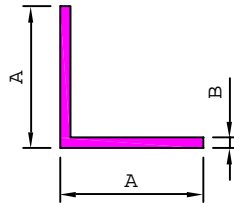

SL. No.	Section No.	A	B	Weight kg/m
1	16442	11.00	0.47	0.027
2	16425	12.00	0.53	0.033
3	16401	12.70	0.75	0.050
4	16402	12.70	1.52	0.098
5	16403	12.70	3.18	0.191
6	16459	15.00	1.30	0.100
7	16443	16.80	0.41	0.037
8	16426	18.00	0.60	0.057
9	16454	19.00	0.80	0.079
10	16404	19.05	0.62	0.064
11	16462	19.05	1.00	0.099
12	16405	19.05	1.31	0.124
13	16450	19.05	1.60	0.158
14	16478	19.05	2.00	0.195
15	16460	19.05	2.25	0.219
16	16436	19.05	2.75	0.262
17	16406	19.05	3.18	0.299
18	16446	20.00	1.20	0.126
19	16486	20.00	2.00	0.205
20	16476	20.20	1.10	0.116
21	16444	21.00	0.49	0.055
22	16427	23.00	0.62	0.076
23	16433	23.50	1.90	0.231
24	16455	25.00	1.30	0.170
25	16424	25.00	1.50	0.196
26	16463	25.00	1.80	0.234
27	16422	25.00	2.00	0.259
28	16441	25.40	0.80	0.108
29	16408	25.40	1.01	0.137

SL. No.	Section No.	A	B	Weight kg/m
30	16407	25.40	1.22	0.163
31	16451	25.40	1.60	0.213
32	16461	25.40	2.10	0.273
33	16474	25.40	2.25	0.295
34	16409	25.40	3.18	0.409
35	16449	25.40	5.00	0.618
36	16456	28.00	1.80	0.263
37	16457	28.00	2.50	0.360
38	16445	29.00	0.59	0.091
39	16464	30.00	1.80	0.283
40	16447	30.00	2.00	0.313
41	16467	30.00	2.30	0.358
42	16468	30.00	2.80	0.432
43	16448	30.00	3.00	0.462
44	16418	30.00	5.00	0.742
45	16431	31.75	0.72	0.122
46	16410	31.75	1.57	0.262
47	16411	31.75	3.00	0.488
48	16472	32.00	5.00	0.797
49	16428	35.00	1.10	0.204
50	16477	35.00	3.40	0.610
51	16458	38.00	2.80	0.553
52	16482	38.00	5.00	0.959
53	16432	38.10	1.22	0.247
54	16412	38.10	1.57	0.316
55	16479	38.10	2.25	0.449
56	16453	38.10	2.50	0.497
57	16483	38.10	2.76	0.546
58	16413	38.10	3.18	0.627

SL. No.	Section No.	A	B	Weight kg/m
59	16414	38.10	4.78	0.921
60	16421	38.10	6.35	1.197
61	16484	38.10	5.80	1.102
62	16452	40.00	2.50	0.523
63	16465	40.00	2.80	0.584
64	16438	40.00	3.00	0.623
65	16471	40.00	3.60	0.742
66	16466	40.00	3.75	0.772
67	16423	40.00	4.00	0.820
68	16435	40.00	5.00	1.013
69	16419	45.00	5.00	1.147
70	16437	50.00	1.00	0.267
71	16469	50.00	2.80	0.735
72	16440	50.00	3.00	0.786
73	16473	50.00	6.00	1.523
74	16481	50.00	8.00	1.987
75	16485	50.00	5.00	1.282
76	16415	50.80	4.78	1.248
77	16430	50.80	6.35	1.633
78	16439	60.00	6.00	1.847
79	16480	63.00	3.00	0.996
80	16416	63.50	4.78	1.577
81	16420	63.50	6.35	2.067
82	16470	75.00	2.70	1.074
83	16475	75.00	3.00	1.191
84	16417	75.00	4.78	1.873
85	16434	76.20	9.52	3.673
86	16429	80.00	8.00	3.283

# ROUND, BULBED, FLANGED TEES & TOP HATS

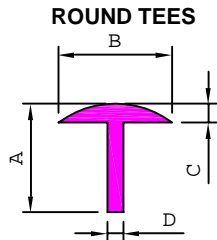

SL. No.	Section No.	A	B	C	D	Weight kg/m
1	17104	20.00	20.00	1.85	0.70	0.110
2	17101	22.20	15.88	3.18	1.60	0.174
3	17102	22.22	22.22	2.85	1.60	0.212

**BULBED TEES - STRAIGHT HEAD**

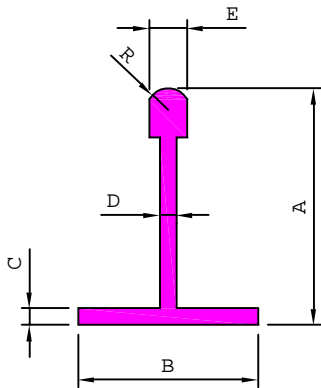

SL. No.	Section No.	A	B	C	D	E	R	Weight kg/m
1	17219	23.50	23.50	0.90	0.90	2.70	-	0.122
2	17210	23.50	23.50	1.20	1.20	3.00	-	0.171
3	17204	23.50	23.50	1.50	1.50	3.00	-	0.202
4	17209	25.00	24.50	0.59	0.59	2.05	-	0.085
5	17213	25.00	24.50	0.65	0.65	2.30	-	0.097
6	17212	25.00	24.50	0.95	0.95	2.50	-	0.136
7	17217	25.00	24.50	0.74	0.74	2.50	-	0.109
8	17211	25.00	25.00	1.17	1.17	3.50	-	0.171
9	17214	25.00	25.00	1.35	1.35	3.50	-	0.195
10	17216	25.00	25.00	1.60	1.60	3.50	-	0.219
11	17218	25.45	40.00	1.45	1.45	2.80	1.40	0.258
12	17203	30.00	30.00	1.60	1.50	2.80	2.50	0.252
13	17215	32.00	32.00	1.45	1.45	2.80	2.50	0.254
14	17206	32.00	32.00	1.60	1.60	2.80	2.50	0.278
15	17208	35.00	23.50	1.50	1.50	3.00	-	0.249
16	17205	36.50	23.50	1.50	1.50	3.00	-	0.254
17	17220	38.00	38.00	1.40	1.40	5.00	2.50	0.329
18	17201	38.10	38.10	1.50	1.60	5.10	2.55	0.357
19	17207	50.80	38.10	1.50	1.50	4.00	-	0.381
20	17202	63.50	38.10	2.03	1.60	5.10	2.55	0.519

**BULBED TEES - TAPERED HEAD**

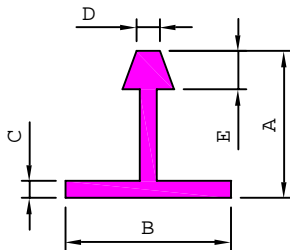

SL. No.	Section No.	A	B	C	D	E	Weight kg/m
1	17303	24.00	24.00	1.40	3.00	2.70	0.192
2	17301	27.00	22.22	1.60	2.80	2.80	0.222
3	17304	36.50	25.00	1.10	2.80	2.80	0.195
4	17302	36.50	25.00	1.60	2.80	2.80	0.270

**FLANGED TEES**

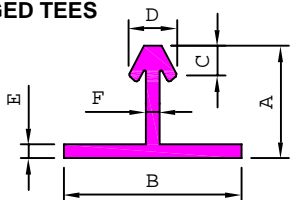

SL. No.	Section No.	A	B	C	D	E	F	Weight kg/m
1	17401	19.05	31.80	5.19	8.00	1.50	1.50	0.240
2	17402	38.10	31.75	7.00	12.00	1.50	1.64	0.360

**TOP HATS**

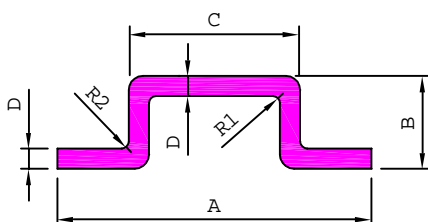

SL. No.	Section No.	A	B	C	D	R1	R2	Weight kg/m
1	17457	31.15	12.70	12.00	3.18	--	--	0.430
2	17456	40.00	16.00	20.00	4.00	--	--	0.690
3	17452	57.15	28.50	23.81	2.39	0.50	0.50	0.706
4	17453	63.50	31.75	25.40	3.18	-	1.60	1.038
5	17458	76.20	44.45	38.10	3.18	4.76	3.18	1.401
6	17455	88.90	44.45	44.45	3.18	3.18	3.18	1.495