

ROUND, BULBED, FLANGED TEES & TOP HATS

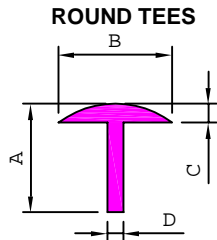

SL. No.	Section No.	A	B	C	D	Weight kg/m
1	17104	20.00	20.00	1.85	0.70	0.110
2	17101	22.20	15.88	3.18	1.60	0.174
3	17102	22.22	22.22	2.85	1.60	0.212

BULBED TEES - STRAIGHT HEAD

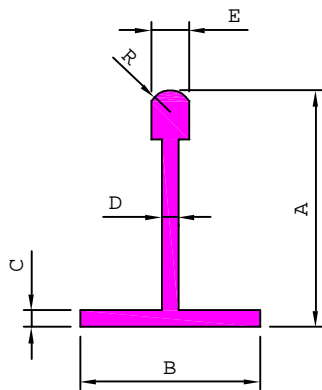

SL. No.	Section No.	A	B	C	D	E	R	Weight kg/m
1	17219	23.50	23.50	0.90	0.90	2.70	-	0.122
2	17210	23.50	23.50	1.20	1.20	3.00	-	0.171
3	17204	23.50	23.50	1.50	1.50	3.00	-	0.202
4	17209	25.00	24.50	0.59	0.59	2.05	-	0.085
5	17213	25.00	24.50	0.65	0.65	2.30	-	0.097
6	17212	25.00	24.50	0.95	0.95	2.50	-	0.136
7	17217	25.00	24.50	0.74	0.74	2.50	-	0.109
8	17211	25.00	25.00	1.17	1.17	3.50	-	0.171
9	17214	25.00	25.00	1.35	1.35	3.50	-	0.195
10	17216	25.00	25.00	1.60	1.60	3.50	-	0.219
11	17218	25.45	40.00	1.45	1.45	2.80	1.40	0.258
12	17203	30.00	30.00	1.60	1.50	2.80	2.50	0.252
13	17215	32.00	32.00	1.45	1.45	2.80	2.50	0.254
14	17206	32.00	32.00	1.60	1.60	2.80	2.50	0.278
15	17208	35.00	23.50	1.50	1.50	3.00	-	0.249
16	17205	36.50	23.50	1.50	1.50	3.00	-	0.254
17	17220	38.00	38.00	1.40	1.40	5.00	2.50	0.329
18	17201	38.10	38.10	1.50	1.60	5.10	2.55	0.357
19	17207	50.80	38.10	1.50	1.50	4.00	-	0.381
20	17202	63.50	38.10	2.03	1.60	5.10	2.55	0.519

BULBED TEES - TAPERED HEAD

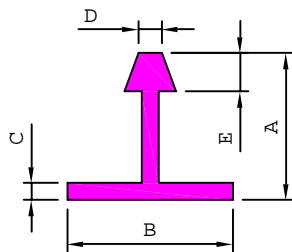

SL. No.	Section No.	A	B	C	D	E	Weight kg/m
1	17303	24.00	24.00	1.40	3.00	2.70	0.192
2	17301	27.00	22.22	1.60	2.80	2.80	0.222
3	17304	36.50	25.00	1.10	2.80	2.80	0.195
4	17302	36.50	25.00	1.60	2.80	2.80	0.270

FLANGED TEES

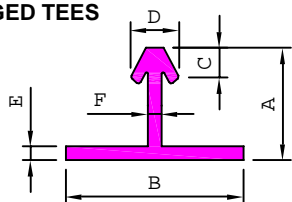

SL. No.	Section No.	A	B	C	D	E	F	Weight kg/m
1	17401	19.05	31.80	5.19	8.00	1.50	1.50	0.240
2	17402	38.10	31.75	7.00	12.00	1.50	1.64	0.360

TOP HATS

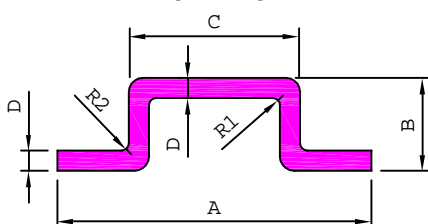

SL. No.	Section No.	A	B	C	D	R1	R2	Weight kg/m
1	17457	31.15	12.70	12.00	3.18	--	--	0.430
2	17456	40.00	16.00	20.00	4.00	--	--	0.690
3	17452	57.15	28.50	23.81	2.39	0.50	0.50	0.706
4	17453	63.50	31.75	25.40	3.18	-	1.60	1.038
5	17458	76.20	44.45	38.10	3.18	4.76	3.18	1.401
6	17455	88.90	44.45	44.45	3.18	3.18	3.18	1.495