

HALF ROUNDS, BELT MOULDINGS & WATER CHANNELS

HALF ROUNDS - RADIUSED

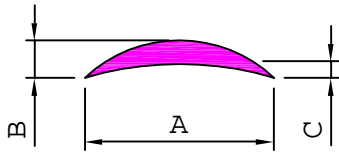

SL. No.	Section No.	A	B	C	Weight kg/m
1	23009	17.65	3.15	1.65	0.058
2	23005	19.00	4.80	0.90	0.152
3	23001	19.05	3.18	0.90	0.091
4	23002	24.00	3.18	1.16	0.099
5	23006	24.70	4.78	0.78	0.193
6	23008	25.00	5.20	2.85	0.127
7	23007	25.15	4.60	1.70	0.150
8	23003	25.40	3.80	1.55	0.121

BELT MOULDINGS

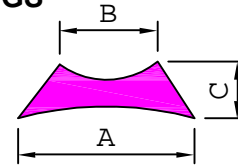

SL. No.	Section No.	A	B	C	Weight kg/m
1	23104	22.00	15.56	3.00	0.088
2	23106	22.50	13.00	2.70	0.055
3	23105	24.20	14.00	3.00	0.078
4	23101	25.15	12.70	3.80	0.114
5	23103	28.58	15.88	11.11	0.476

WATER CHANNELS

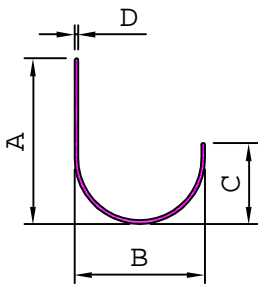

SL. No.	Section No.	A	B	C	D	Weight kg/m
1	23507	23.50	18.50	11.50	0.52	0.063
2	23505	23.50	18.50	11.50	0.65	0.078
3	23510	23.50	18.50	11.50	0.71	0.085
4	23508	25.00	11.50	14.00	0.71	0.085
5	23506	25.40	12.00	12.70	1.06	0.124
6	23501	25.40	12.70	11.43	1.40	0.157
7	23502	25.40	19.05	12.70	0.75	0.098
8	23503	25.40	19.05	12.70	1.68	0.210
9	23509	25.50	12.90	13.60	1.45	0.173

POULTRY CHANNELS

23202

0.303 kg/m

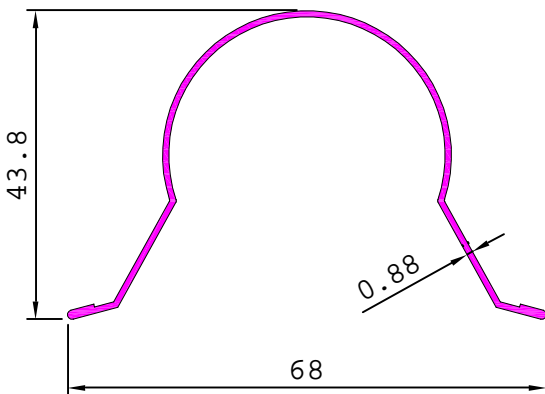

23204

0.714 kg/m

