

SQUARE TUBES & FLUTED ROUND TUBES

SQUARE TUBES

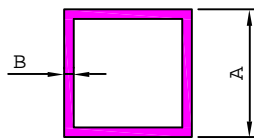

| SL. No. | Section No. | A | B | Weight kg/m |
|---------|-------------|-------|------|-------------|
| 1 | 14490 | 11.00 | 0.60 | 0.067 |
| 2 | 14519 | 12.00 | 0.55 | 0.068 |
| 3 | 14481 | 12.00 | 0.64 | 0.078 |
| 4 | 14485 | 12.70 | 0.81 | 0.104 |
| 5 | 14451 | 12.70 | 1.22 | 0.151 |
| 6 | 14452 | 12.70 | 1.63 | 0.195 |
| 7 | 14502 | 15.88 | 1.27 | 0.200 |
| 8 | 14491 | 16.00 | 1.00 | 0.162 |
| 9 | 14478 | 17.00 | 0.62 | 0.109 |
| 10 | 14474 | 17.50 | 1.44 | 0.245 |
| 11 | 14472 | 18.00 | 1.22 | 0.221 |
| 12 | 14512 | 18.15 | 0.64 | 0.121 |
| 13 | 14486 | 18.50 | 0.69 | 0.133 |
| 14 | 14496 | 18.50 | 0.90 | 0.171 |
| 15 | 14482 | 19.05 | 1.13 | 0.219 |
| 16 | 14453 | 19.05 | 1.22 | 0.235 |
| 17 | 14454 | 19.05 | 1.63 | 0.307 |
| 18 | 14521 | 20.00 | 1.50 | 0.299 |
| 19 | 14509 | 20.00 | 1.70 | 0.335 |
| 20 | 14483 | 22.50 | 0.55 | 0.130 |
| 21 | 14479 | 22.50 | 0.63 | 0.148 |
| 22 | 14487 | 23.00 | 0.76 | 0.182 |
| 23 | 14477 | 23.50 | 0.87 | 0.212 |
| 24 | 14469 | 23.50 | 1.02 | 0.247 |
| 25 | 14520 | 24.50 | 0.67 | 0.172 |
| 26 | 14470 | 25.00 | 1.50 | 0.381 |
| 27 | 14504 | 25.00 | 1.80 | 0.451 |
| 28 | 14516 | 25.00 | 2.80 | 0.671 |
| 29 | 14476 | 25.40 | 0.90 | 0.238 |
| 30 | 14466 | 25.40 | 1.25 | 0.326 |
| 31 | 14455 | 25.40 | 1.63 | 0.418 |
| 32 | 14456 | 25.40 | 2.00 | 0.505 |
| 33 | 14465 | 25.40 | 2.41 | 0.598 |
| 34 | 14523 | 28.00 | 2.00 | 0.562 |
| 35 | 14505 | 30.00 | 1.80 | 0.548 |
| 36 | 14497 | 30.00 | 3.00 | 0.874 |
| 37 | 14467 | 31.75 | 1.25 | 0.412 |
| 38 | 14457 | 31.75 | 1.63 | 0.530 |
| 39 | 14458 | 31.75 | 2.00 | 0.643 |
| 40 | 14475 | 32.00 | 2.60 | 0.825 |
| 41 | 14488 | 35.00 | 0.93 | 0.342 |
| 42 | 14513 | 35.00 | 2.00 | 0.712 |
| 43 | 14524 | 37.50 | 0.80 | 0.317 |
| 44 | 14468 | 38.10 | 1.25 | 0.497 |
| 45 | 14511 | 38.10 | 1.37 | 0.547 |
| 46 | 14459 | 38.10 | 1.63 | 0.642 |
| 47 | 14460 | 38.10 | 2.00 | 0.780 |
| 48 | 14461 | 38.10 | 2.41 | 0.929 |
| 49 | 14518 | 40.00 | 0.80 | 0.339 |
| 50 | 14506 | 40.00 | 1.80 | 0.743 |
| 51 | 14480 | 40.00 | 3.00 | 1.198 |

| SL. No. | Section No. | A | B | Weight kg/m |
|---------|-------------|--------|------|-------------|
| 52 | 14514 | 40.00 | 2.85 | 1.143 |
| 53 | 14522 | 44.45 | 2.00 | 0.917 |
| 54 | 14473 | 44.46 | 3.20 | 1.426 |
| 55 | 14471 | 50.00 | 1.18 | 0.621 |
| 56 | 14525 | 50.00 | 1.50 | 0.785 |
| 57 | 14510 | 50.00 | 1.70 | 0.887 |
| 58 | 14462 | 50.00 | 2.00 | 1.037 |
| 59 | 14515 | 50.00 | 2.30 | 1.185 |
| 60 | 14503 | 50.00 | 2.70 | 1.379 |
| 61 | 14463 | 50.80 | 2.40 | 1.254 |
| 62 | 14464 | 50.80 | 3.05 | 1.573 |
| 63 | 14498 | 60.00 | 4.00 | 2.419 |
| 64 | 14500 | 62.00 | 3.80 | 2.388 |
| 65 | 14489 | 62.00 | 5.00 | 3.078 |
| 66 | 14492 | 63.50 | 2.38 | 1.571 |
| 67 | 14507 | 75.00 | 2.70 | 2.108 |
| 68 | 14493 | 76.20 | 2.38 | 1.897 |
| 69 | 14494 | 87.00 | 3.80 | 3.415 |
| 70 | 14484 | 87.00 | 4.00 | 3.586 |
| 71 | 14495 | 87.00 | 5.00 | 4.428 |
| 72 | 14508 | 100.00 | 3.00 | 3.142 |
| 73 | 14517 | 101.60 | 3.18 | 3.374 |

FLUTED ROUND TUBES

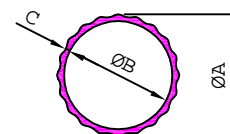

| SL. No. | Section No. | ØA | ØB | C | Weight kg/m |
|---------|-------------|-------|-------|------|-------------|
| 1 | 14904 | 18.50 | 16.30 | 0.68 | 0.114 |
| 2 | 14907 | 18.50 | 17.26 | 0.41 | 0.078 |
| 3 | 14913 | 18.80 | 16.70 | 0.70 | 0.127 |
| 4 | 14901 | 19.05 | 16.90 | 0.70 | 0.130 |
| 5 | 14910 | 20.50 | 17.70 | 0.90 | 0.186 |
| 6 | 14909 | 20.70 | 19.20 | 0.52 | 0.109 |
| 7 | 14915 | 24.00 | 22.62 | 0.49 | 0.114 |
| 8 | 14903 | 24.80 | 22.60 | 0.70 | 0.179 |
| 9 | 14916 | 24.80 | 22.97 | 0.67 | 0.156 |
| 10 | 14906 | 24.80 | 23.52 | 0.44 | 0.111 |
| 11 | 14902 | 25.40 | 20.34 | 1.83 | 0.410 |
| 12 | 14914 | 25.40 | 22.01 | 0.93 | 0.252 |
| 13 | 14912 | 25.40 | 22.07 | 0.90 | 0.247 |
| 14 | 14908 | 25.40 | 22.20 | 0.79 | 0.226 |
| 15 | 14905 | 28.00 | 25.50 | 0.80 | 0.237 |
| 16 | 14911 | 28.00 | 26.32 | 0.63 | 0.171 |