

MISCELLANEOUS BARS

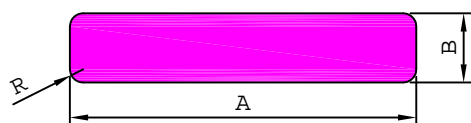

SL. No.	Section No.	A	B	R	Weight kg/m
1	12182	6.80	2.00	0.60	0.036
2	12183	8.50	2.00	0.60	0.045
3	12163	17.90	14.90	2.25	0.708
4	S3731	28.00	9.00	1.50	0.675
5	12180	30.00	16.00	1.00	1.294
6	12134	40.00	10.00	3.00	1.059
7	S3730	40.00	11.00	1.50	1.183
8	12147	40.00	26.00	3.00	2.787
9	12086	50.00	8.00	3.00	1.059
10	12217	50.00	8.00	3.00	1.059
11	12135	50.00	10.00	3.00	1.329
12	12096	50.00	12.00	3.00	1.599
13	12186	50.05	8.00	3.00	1.060
14	S3729	55.00	15.00	2.00	2.218
15	12128	60.00	10.00	1.00	1.618
16	12136	60.00	10.00	3.00	1.559
17	12092	65.00	8.00	3.00	1.383
18	12215	65.00	8.00	3.00	1.383
19	12185	65.05	8.00	3.00	1.383
20	12243	75.00	10.00	3.00	2.004
21	12023	80.00	10.00	3.00	2.138
22	12200	88.90	50.80	1.00	12.191
23	12201	88.90	63.50	1.00	15.240
24	12131	90.00	75.00	0.50	18.225
25	12137	100.00	10.00	3.00	2.679
26	12114	100.00	12.00	3.00	3.219
27	12069	101.60	9.52	1.50	2.606
28	12199	101.60	15.88	1.00	4.354
29	12206	101.60	44.45	1.00	12.191
30	12250	110.50	12.00	1.00	3.578
31	12212	110.50	77.00	1.00	22.971
32	12202	114.30	88.90	1.00	27.433
33	12165	115.00	79.00	1.00	24.527
34	12172	116.00	88.00	1.00	27.559
35	12141	120.00	10.00	3.00	3.219
36	12113	120.00	12.00	3.00	3.867
37	12115	120.00	16.00	3.00	5.163
38	12105	120.00	45.00	1.00	14.578
39	12080	120.00	100.00	2.00	32.391
40	12203	127.00	101.60	1.20	34.835
41	12124	130.00	17.00	1.00	5.965
42	12091	130.00	100.00	1.00	35.098
43	12138	140.00	10.00	3.00	3.759
44	12159	140.00	35.00	1.00	13.228
45	12145	140.00	110.00	1.00	41.578
46	12221	144.00	74.00	2.00	28.762
47	12133	145.00	4.80	1.00	1.877
48	12252	145.00	27.00	1.00	10.568

SL. No.	Section No.	A	B	R	Weight kg/m
49	12251	145.00	68.00	1.00	26.620
50	12170	148.00	93.00	1.00	37.160
51	12224	150.00	22.00	1.00	8.908
52	12230	150.00	100.00	1.00	40.498
53	12219	151.00	7.80	2.00	3.171
54	12104	151.00	111.00	2.00	45.245
55	12253	152.00	16.00	1.00	6.564
56	12127	152.00	80.00	1.00	32.830
57	12205	152.40	76.20	1.00	31.352
58	12232	155.00	13.00	1.00	5.438
59	12130	155.00	58.00	1.00	24.271
60	12098	160.00	10.00	3.00	4.299
61	12168	160.00	85.00	1.00	36.718
62	12126	160.00	90.00	1.00	38.878
63	12255	160.00	115.00	1.00	49.678
64	12179	161.00	40.00	1.00	17.386
65	12171	163.00	39.00	1.00	17.162
66	S4035	165.00	6.35	3.00	2.808
67	12055	165.00	85.00	2.00	37.858
68	12160	165.00	120.00	1.00	53.458
69	12140	168.00	133.00	1.00	60.326
70	12132	169.00	4.80	1.00	2.188
71	12112	169.00	47.00	1.00	21.444
72	12169	170.00	77.00	1.00	35.341
73	S3510	170.00	80.00	2.00	36.711
74	12109	180.00	10.00	3.00	4.839
75	12242	180.00	30.00	2.00	14.571
76	12241	180.00	63.00	1.00	30.616
77	12071	185.00	15.00	1.00	7.490
78	S3909	200.00	6.00	0.70	3.239
79	12139	200.00	10.00	3.00	5.379
80	12065	200.00	20.00	1.00	10.800
81	12118	200.00	32.00	1.00	17.278
82	12226	200.00	55.00	2.00	29.691
83	12190	203.00	52.00	1.00	28.499
84	12191	203.00	62.00	1.00	33.980
85	12087	203.20	9.52	3.00	5.202
86	12207	204.00	26.00	2.00	14.312
87	12070	205.00	15.00	1.00	8.300
88	12204	208.00	12.70	1.00	7.130
89	12083	212.00	38.00	2.00	21.742
90	12123	212.00	48.00	1.00	27.473
91	12177	215.00	76.20	1.00	44.232
92	12173	220.00	12.30	2.00	7.297
93	12078	222.00	32.00	1.50	19.176
94	12103	223.00	18.00	1.00	10.835
95	12108	225.00	14.50	2.00	8.799
96	12129	225.00	17.50	3.00	10.610
97	12213	225.00	50.00	2.00	30.366
98	12074	233.00	17.00	1.00	10.692
99	12084	250.00	18.00	1.50	12.145
100	12054	250.00	30.00	2.50	20.236
101	12167	254.00	21.50	1.00	14.742

MISCELLANEOUS BARS

SL. No.	Section No.	A	B	R	Weight kg/m
102	12097	255.00	17.50	1.50	12.044
103	12063	255.00	23.00	1.00	15.833
104	12090	256.00	4.82	2.00	3.322
105	12088	256.00	9.52	2.00	6.571
106	12188	260.00	22.00	2.00	15.435
107	12081	260.00	23.00	2.00	16.137
108	12110	265.00	18.00	2.00	12.879
109	12110	265.00	18.00	2.00	12.879
110	12235	267.00	22.00	2.00	15.851
111	12196	270.00	22.00	4.00	16.001
112	12064	276.00	23.00	2.00	17.130
113	12082	284.00	18.00	2.00	13.793
114	12085	285.00	23.00	2.00	17.699
115	12195	290.00	29.00	4.00	22.670
116	12236	292.00	23.00	4.00	18.096
117	12222	300.00	36.00	1.00	29.158
118	12056	305.00	6.00	1.00	4.939
119	12057	305.00	8.00	1.00	6.586
120	12197	305.00	20.00	1.00	16.468
121	12210	425.00	3.00	1.00	3.440
122	12218	425.00	5.00	1.00	5.735
123	12244	426.00	30.00	6.00	34.423

FLAT BAR WITH FULL RADIUS

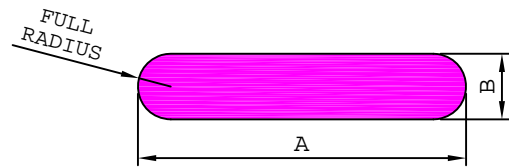

SL. No.	Section No.	A	B	Weight kg/m
1	12030	25.20	6.30	0.405
2	12209	30.00	13.00	0.955
3	12039	40.00	10.00	1.022
4	12231	40.00	15.00	1.490
5	12117	50.00	6.00	0.789
6	12001	50.00	10.00	1.292
7	12111	50.00	12.00	1.537
8	12046	50.40	6.30	0.834
9	12229	60.00	5.00	0.796
10	12245	60.00	6.00	0.951
11	12075	60.00	6.20	0.982
12	12198	61.00	7.50	1.203
13	12041	63.50	6.35	1.065
14	12116	75.00	6.00	1.194
15	12150	76.20	9.52	1.906
16	12234	80.00	3.00	0.643
17	12100	100.00	6.00	1.599
18	12246	100.00	6.00	1.599
19	12144	100.00	12.00	3.157
20	12050	101.60	6.35	1.720
21	12238	120.00	3.00	0.967
22	12237	120.00	5.00	1.606
23	12211	120.00	6.00	1.923
24	12227	140.00	6.00	2.247
25	12102	150.00	6.00	2.409
26	12193	150.00	10.00	3.992
27	12042	152.40	6.35	2.590
28	12239	175.00	6.00	2.814
29	12228	185.00	6.00	2.976
30	12068	200.00	12.00	6.397
31	12208	240.00	6.00	3.867
32	12216	240.00	6.00	3.867
33	12192	300.00	10.00	8.042

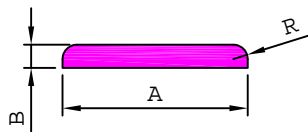

SL. No.	Section No.	A	B	R	Weight kg/m
1	12010	25.40	3.18	1.98	0.213
2	12089	25.00	2.95	2.00	0.194

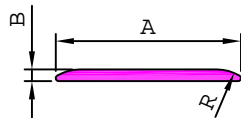

SL. No.	Section No.	A	B	R	Weight kg/m
1	12016	25.40	1.60	6.00	0.104
2	12017	25.40	1.88	6.00	0.120
3	12095	24.75	1.17	1.00	0.077

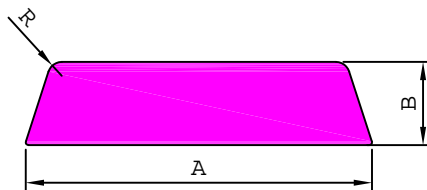

SL. No.	Section No.	A	B	R1	Weight kg/m
1	12120	50.00	12.00	2.00	1.501
2	12121	50.00	12.00	8.00	1.469
3	12122	40.00	8.00	2.00	0.812

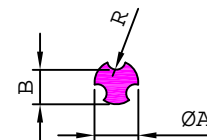

SL. No.	Section No.	A	B	R	Weight kg/m
1	12049	5.60	4.55	1.25	0.052
2	12024	5.80	4.30	1.50	0.045
3	12004	6.00	4.75	1.25	0.057
4	12021	6.00	4.50	1.20	0.053
5	12038	6.30	4.70	1.19	0.059

MISCELLANEOUS BARS

<p>12002 0.403 kg/m</p>	<p>12006 0.483 kg/m</p>	<p>12007 0.584 kg/m</p>
<p>12008 0.801 kg/m</p>	<p>12009 0.399 kg/m</p>	<p>12011 0.040 kg/m</p>
<p>12026 0.197 kg/m</p>	<p>12047 2.009 kg/m</p>	<p>12067 0.571 kg/m</p>
<p>12077 1.151 kg/m</p>	<p>12079 0.563 kg/m</p>	<p>12093 0.381 kg/m</p>
<p>12106 0.424 kg/m</p>	<p>12107 0.495 kg/m</p>	<p>12149 1.120 kg/m</p>
<p>12151 0.267 kg/m</p>	<p>12152 0.811 kg/m</p>	<p>12154 0.116 kg/m</p>

MISCELLANEOUS BARS

12153

6.610 kg/m

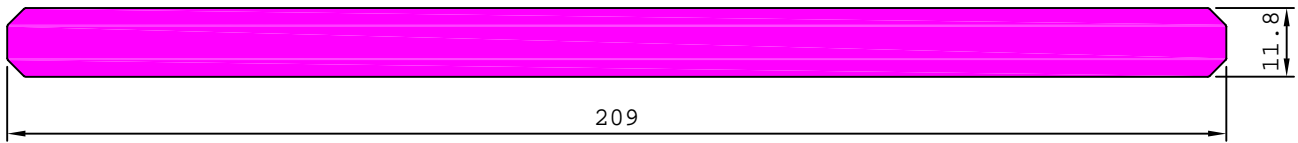

12155

0.066 kg/m

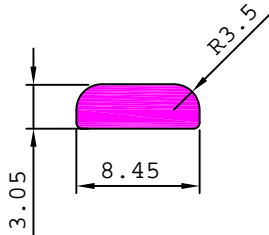

12156

0.035 kg/m

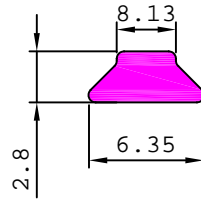

12166

1.271 kg/m

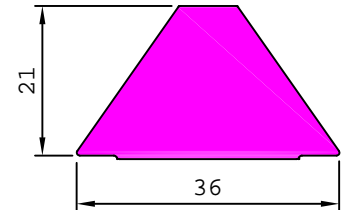

12158

2.191 kg/m

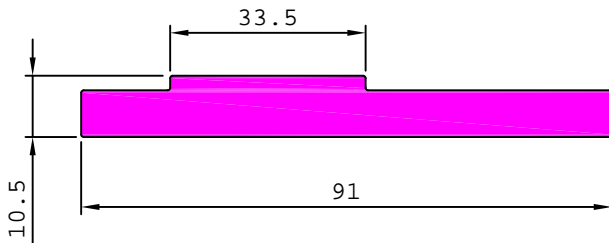

12174

2.311 kg/m

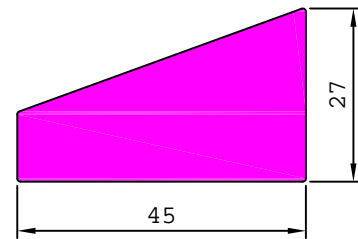

12176

0.191 kg/m

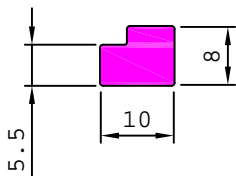

12178

2.089 kg/m

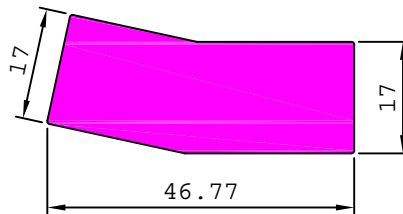

12181

0.161 kg/m

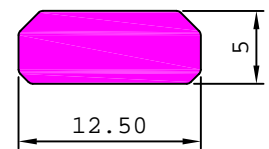

12184

2.505 kg/m

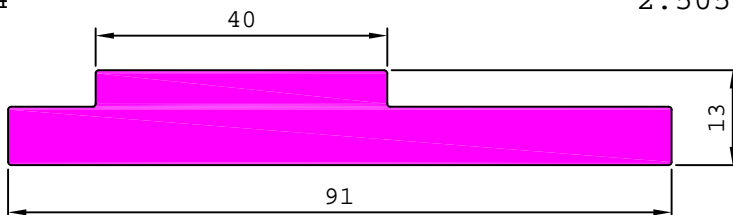

12189

0.144 kg/m

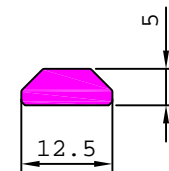

12194

0.168 kg/m

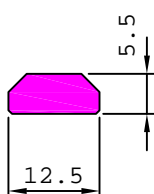

12094

0.196 kg/m

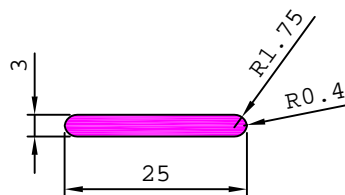

12223

0.115 kg/m

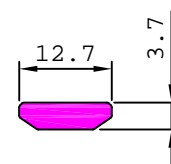

MISCELLANEOUS BARS

12214

10.435 kg/m

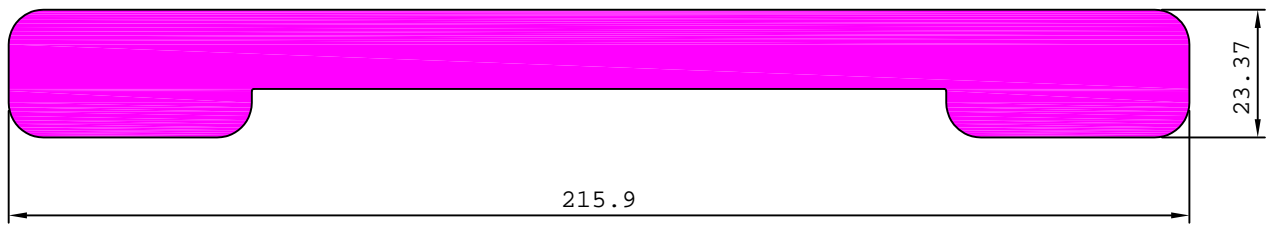

12225

0.253 kg/m

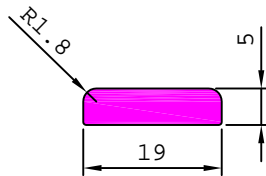

12247

0.031 kg/m

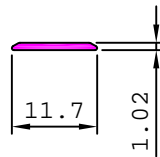

12248

0.068 kg/m

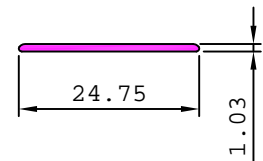

12249

0.093 kg/m

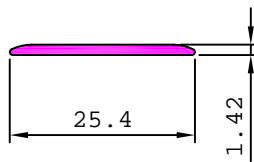

27974

3.347 kg/m

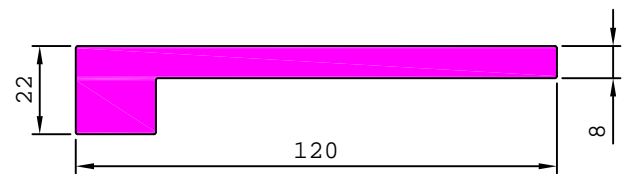

27946

15.700 kg/m

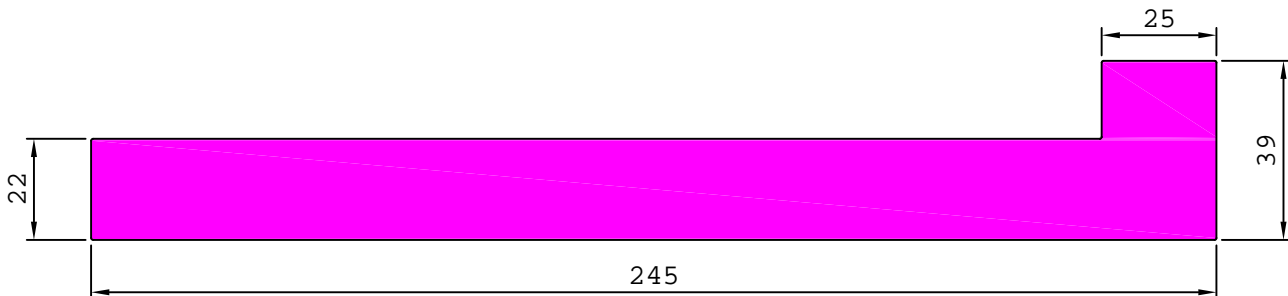

28924

0.116 kg/m

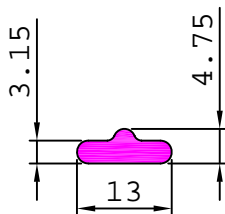

28931

6.312 kg/m

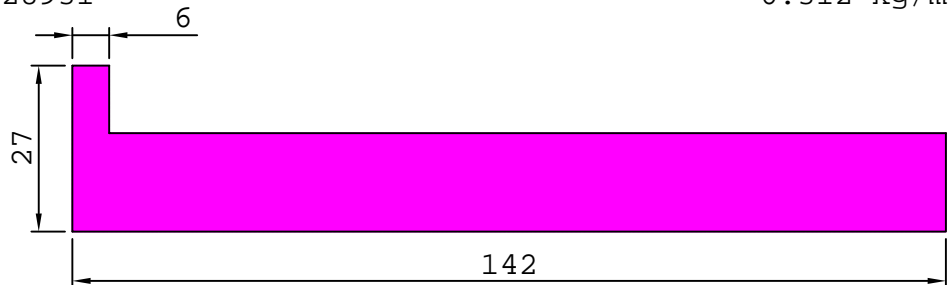

29006

0.117 kg/m

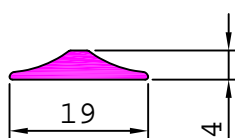

29007

0.149 kg/m

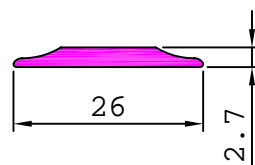

29008

0.110 kg/m

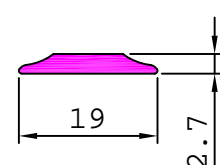

MISCELLANEOUS BARS

29065

3.022 kg/m

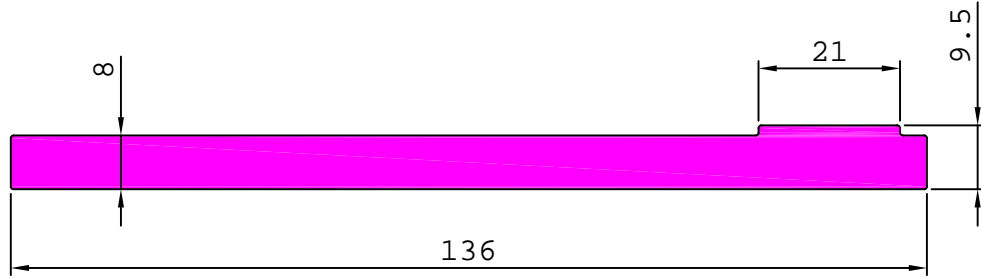

S4164

0.063 kg/m

