

HANDLE SECTIONS

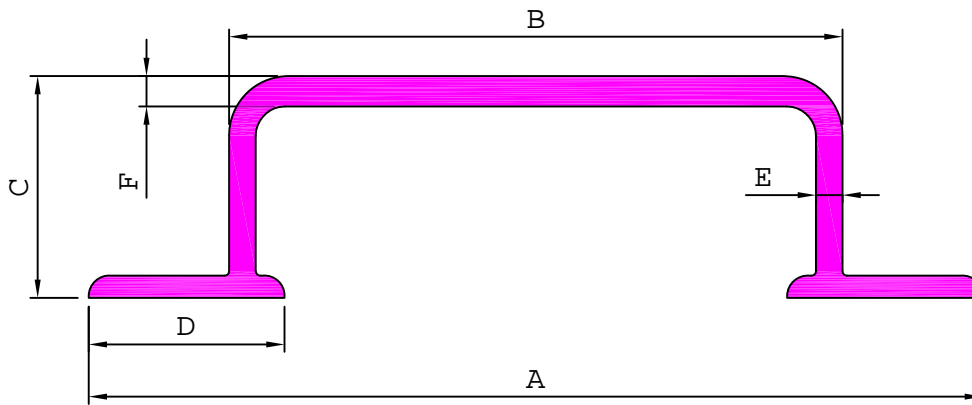

SL. No.	Section No.	A	B	C	D	E	F	Weight kg/m
1	18593	98.00	62.00	24.00	24.00	2.37	2.37	0.875
2	18624	121.00	83.00	30.00	26.50	2.90	3.60	1.502
3	18605	121.00	83.00	30.00	26.50	3.10	3.90	1.613
4	18617	121.00	83.00	30.00	26.50	3.60	4.10	1.720
5	18628	121.00	83.00	30.00	26.50	3.90	3.90	1.652
6	18639	123.00	82.00	29.00	26.50	2.00	2.60	1.075
7	18569	124.80	85.00	34.00	30.00	3.40	3.40	1.759
8	18618	124.80	85.00	34.00	30.00	4.00	4.20	1.992
9	18634	126.00	84.00	30.50	29.70	3.80	3.80	1.798
10	18602	126.00	84.00	30.50	29.70	4.15	4.20	1.917
11	18573	126.00	86.00	34.00	30.00	4.42	4.42	2.104
12	18623	137.60	97.00	29.40	24.80	2.40	2.70	1.277
13	18638	142.00	99.00	29.50	27.20	2.20	2.20	1.337
14	18625	143.00	105.00	30.00	26.50	3.10	3.60	1.780
15	18606	143.00	105.00	30.00	26.50	3.20	4.00	1.885
16	18586	148.80	106.50	33.00	27.30	3.90	4.20	2.105
17	18640	149.50	107.00	31.00	30.50	3.85	3.85	2.066
18	18603	149.50	107.00	31.00	30.50	4.00	4.00	2.192
19	18629	150.00	110.00	34.00	30.00	3.40	3.40	1.925
20	18619	150.00	110.00	34.00	30.00	3.45	3.60	1.995
21	18572	150.00	110.00	34.00	30.00	3.66	3.66	2.127
22	18620	150.00	110.00	34.00	30.00	4.00	4.10	2.248
23	18571	150.00	110.00	34.00	30.00	4.32	4.32	2.374

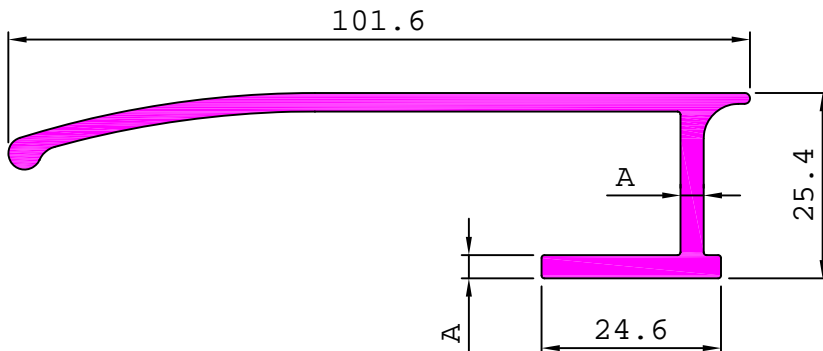

SL. No.	Section No.	A	Weight kg/m
1	18553	3.18	1.093
2	18604	2.10	0.852

HANDLE SECTIONS

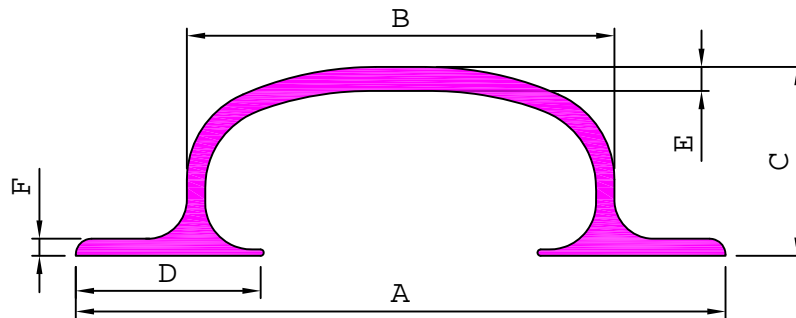

SL. No.	Section No.	A	B	C	D	E	F	Weight kg/m
1	18611	123.00	82.50	34.50	30.00	2.45	2.20	1.258
2	18635	123.00	82.50	34.50	30.00	2.05	2.00	1.079
3	18594	123.00	82.50	34.50	30.00	2.87	2.50	1.422
4	18607	126.00	83.50	36.00	30.00	3.40	2.45	1.613
5	18587	127.00	84.00	37.00	36.50	3.35	2.85	1.742
6	18632	127.00	84.00	37.00	36.50	3.40	2.90	1.790
7	18621	127.00	84.00	37.00	36.50	3.90	3.10	1.996
8	18612	128.00	84.00	37.00	30.00	3.00	2.80	1.530
9	18630	128.00	84.00	37.00	30.00	3.30	3.00	1.647
10	18613	128.00	84.00	37.00	30.00	3.50	3.10	1.724
11	18636	140.00	98.00	34.50	30.00	2.45	2.30	1.351
12	18614	140.00	98.00	34.50	30.00	2.90	2.35	1.531
13	18595	140.00	98.00	34.50	30.00	3.25	2.60	1.695
14	18633	142.00	98.00	37.00	38.50	3.70	3.00	2.062
15	18588	142.00	98.00	37.00	38.50	3.90	3.00	2.156
16	18622	142.00	98.00	37.00	38.50	4.15	3.20	2.270
17	18615	143.00	99.00	36.00	32.00	3.40	2.55	1.805
18	18608	143.00	99.00	36.00	32.00	3.60	2.65	1.885
19	18631	143.00	99.00	36.00	32.00	3.70	2.70	1.921
20	18616	143.00	99.00	36.00	32.00	3.90	2.70	1.994

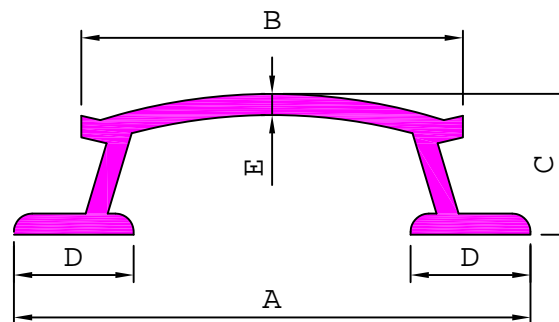

SL. No.	Section No.	A	B	C	D	E	Weight kg/m
1	18562	122.00	90.00	32.00	29.00	3.80	1.920
2	18583	144.00	112.00	35.00	28.00	4.80	2.378
3	18563	148.00	114.00	34.00	29.00	4.00	2.091

HANDLE SECTIONS

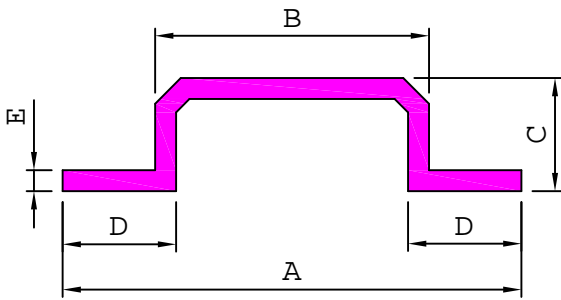

SL. No.	Section No.	A	B	C	D	E	Weight kg/m
1	18592	83.40	51.00	24.00	18.20	2.00	0.685
2	18575	83.40	51.00	24.00	19.20	3.00	0.951
3	18554	101.60	76.20	31.75	16.20	3.81	1.467
4	18591	102.40	70.00	26.80	18.40	1.98	0.885
5	18576	102.40	70.00	26.80	19.00	2.80	1.074

18558

1.438 kg/m

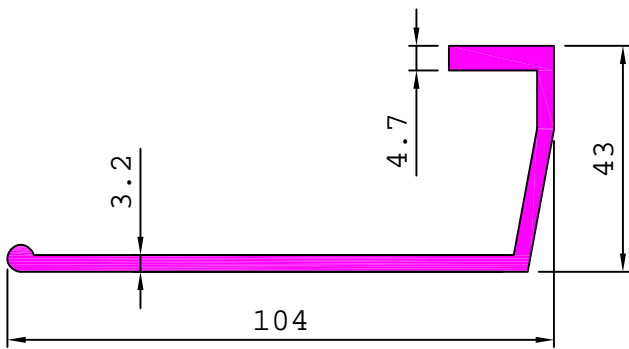

18560

1.709 kg/m

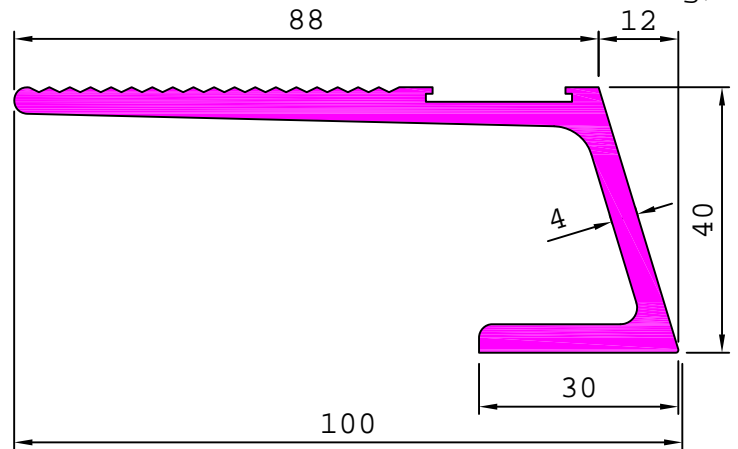

18565

0.491 kg/m

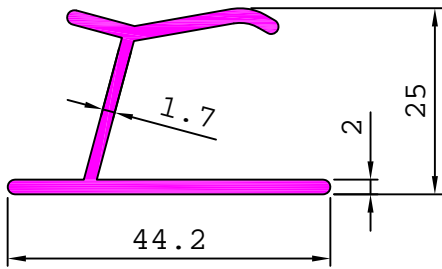

18570

0.942 kg/m

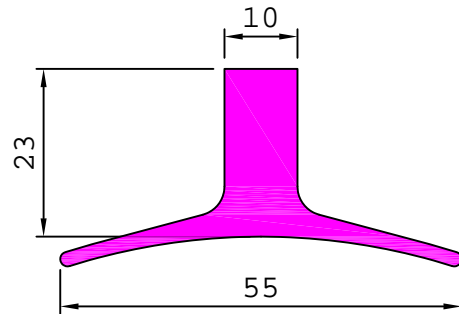

18577

0.351 kg/m

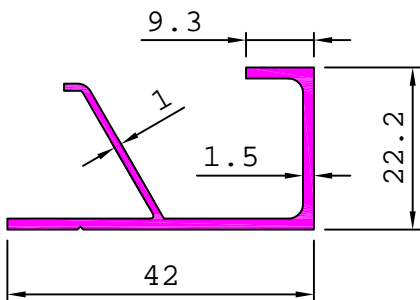

18637

1.584 kg/m

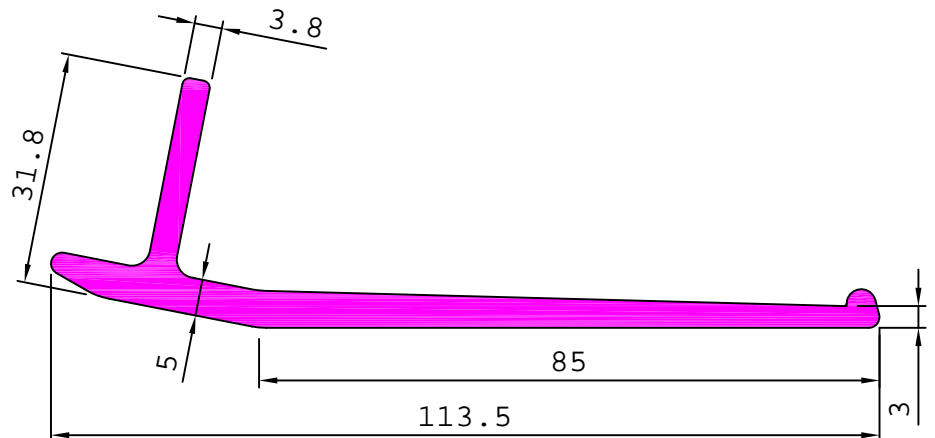

HANDLE SECTIONS

18641

0.707 kg/m

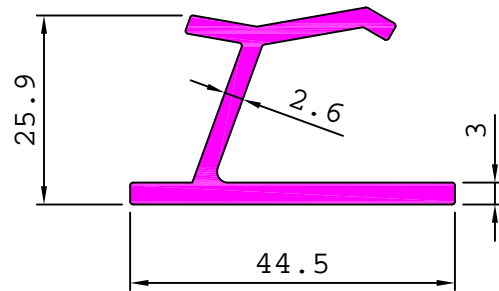

18643

7.668 kg/m

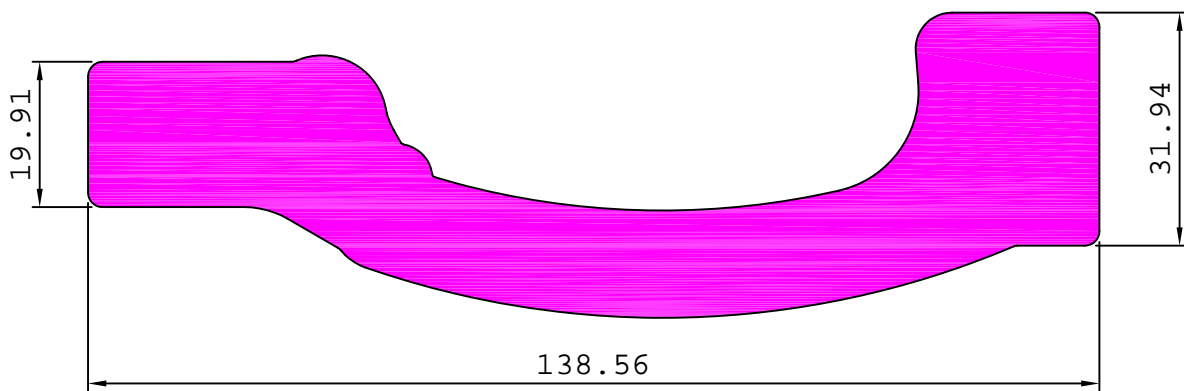

18644

9.441 kg/m

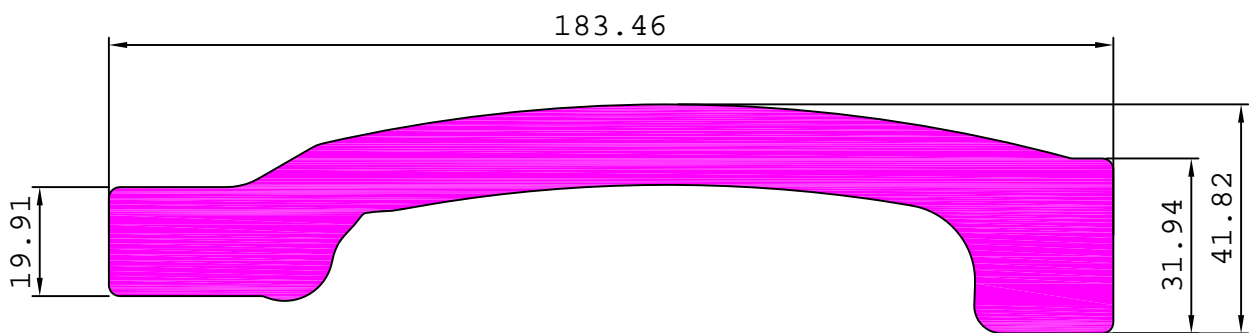

29426

13.076 kg/m

